



FAQ / Application Note

Subject: One Click to gather all system info. for further debugging

FAQ Document No: S23003

Date: 2023/3/31

Model Name: HPM models

Rev: A1

Category: General H/W S/W Others, 寫小分類

Purpose:

How to get system information file from BMC WEB UI.

Please connect to BMC Web interface and follow the steps below to download the system information file.

Go to Maintenance → Download Service Date

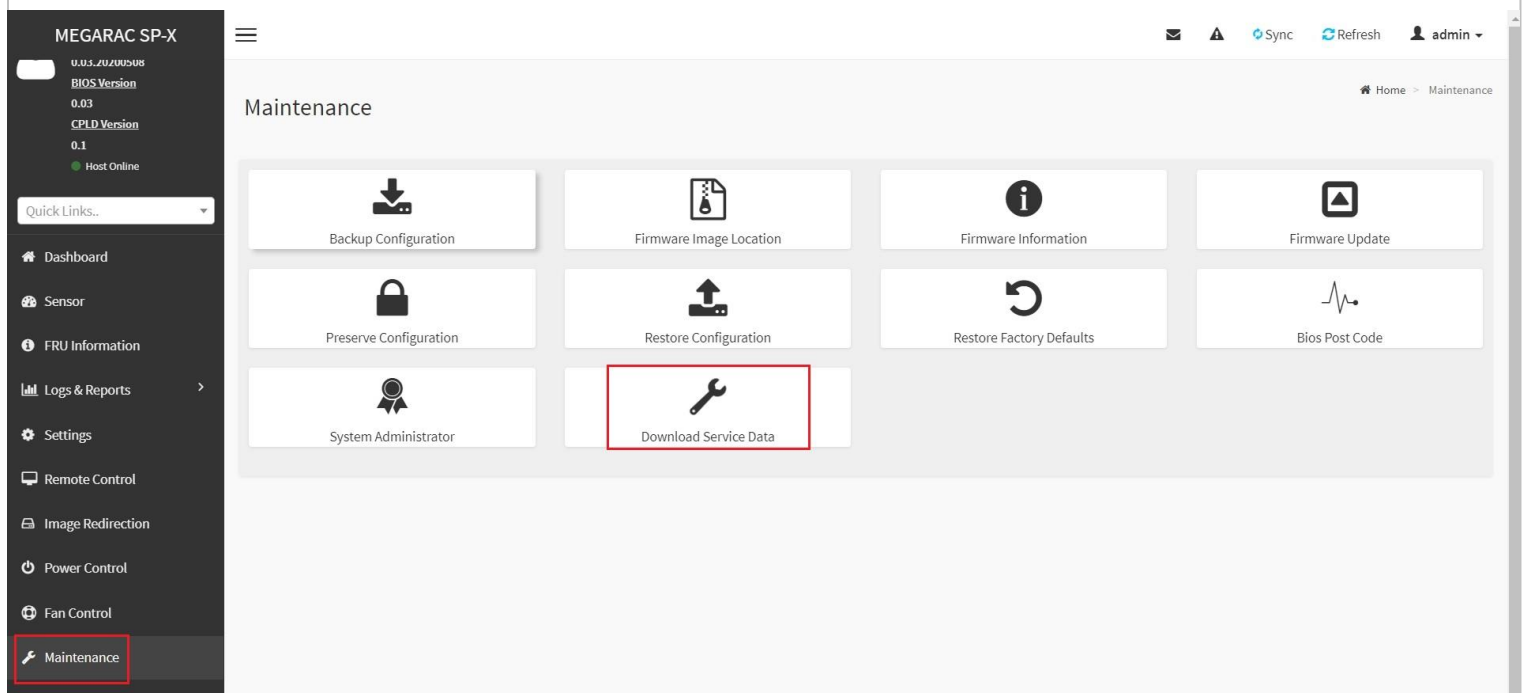

Avalue Technology Inc.

7F, 228, Lian-cheng Road, Zhonghe Dist., New Taipei City 235, Taiwan

www.avalue.com.tw
 sales@avalue.com.tw
 Tel: +886-2-8226-2345
 Fax: +886-2-8226-2777

Avalue USA
 sales@avalue-usa.com
 Tel: +732-414-6500
 Fax: +732-414-6501

Avalue Japan
 sales.japan@avalue.co.jp
 Tel: +81-3-5807-2321
 Fax: +81-3-5807-2322

Avalue China
 sales.china@avalue.com.cn
 Tel: +86-21-5169-3609
 Fax: +86-21-5445-3266

Avalue European Service Centre
 eu_rma_service@avalue.com.tw
 Tel: +31-251-7002-87



It will show the Download Service Date screen, please click on the green download item.

MEGARAC SP-X

U.03.20200508
BIOS Version
0.03
CPLD Version
0.1
● Host Online

Quick Links..

- Dashboard
- Sensor
- FRU Information
- Logs & Reports
- Settings
- Remote Control
- Image Redirection
- Power Control
- Fan Control
- Maintenance
- Sign out

Download Service Data

Download Service Data

Download Service Data ?

Click the button, and BMC starts to collect data. After collection, data will be downloaded automatically.

[Download Service Data](#)

Avalue Technology Inc.

7F, 228, Lian-cheng Road, Zhonghe Dist., New Taipei City 235, Taiwan

www.avalue.com.tw
sales@avalue.com.tw
Tel: +886-2-8226-2345
Fax: +886-2-8226-2777

Avalue USA
sales@avalue-usa.com
Tel: +732-414-6500
Fax: +732-414-6501

Avalue Japan
sales.japan@avalue.co.jp
Tel: +81-3-5807-2321
Fax: +81-3-5807-2322





Avalue China
sales.china@avalue.com.cn
Tel: +86-21-5169-3609
Fax: +86-21-5445-3266

Avalue European Service Centre
eu_rma_service@avalue.com.tw
Tel: +31-251-7002-87



Then you will get the following file in .tar format, there are four folders in the .tar file, the main system information will be in the conf and tmp folders. These databases contain all the SOC boot data / linux data which will also contain SEL, just provide this tar file to us for further analysis.

 mini_ffdc_2022_09_26_9_59_0.tar

 conf	2022/9/26 上午 09:56	檔案資料夾
 extlog	2022/9/26 上午 09:59	檔案資料夾
 info	2022/9/26 上午 09:59	檔案資料夾
 tmp	2022/9/26 上午 10:00	檔案資料夾

Avalue Technology Inc.

7F, 228, Lian-cheng Road, Zhonghe Dist., New Taipei City 235, Taiwan

www.avalue.com.tw
sales@avalue.com.tw
Tel: +886-2-8226-2345
Fax: +886-2-8226-2777

Avalue USA
sales@avalue-usa.com
Tel: +732-414-6500
Fax: +732-414-6501

Avalue Japan
sales.japan@avalue.co.jp
Tel: +81-3-5807-2321
Fax: +81-3-5807-2322

Avalue China
sales.china@avalue.com.cn
Tel: +86-21-5169-3609
Fax: +86-21-5445-3266

Avalue European Service Centre
eu_rma_service@avalue.com.tw
Tel: +31-251-7002-87